

GCE AS/A LEVEL ART AND DESIGN
ARTIST'S SKETCHBOOK THAT USES CONTEXTUAL
SOURCES TO INFORM THE APPROACH OF THE ARTIST

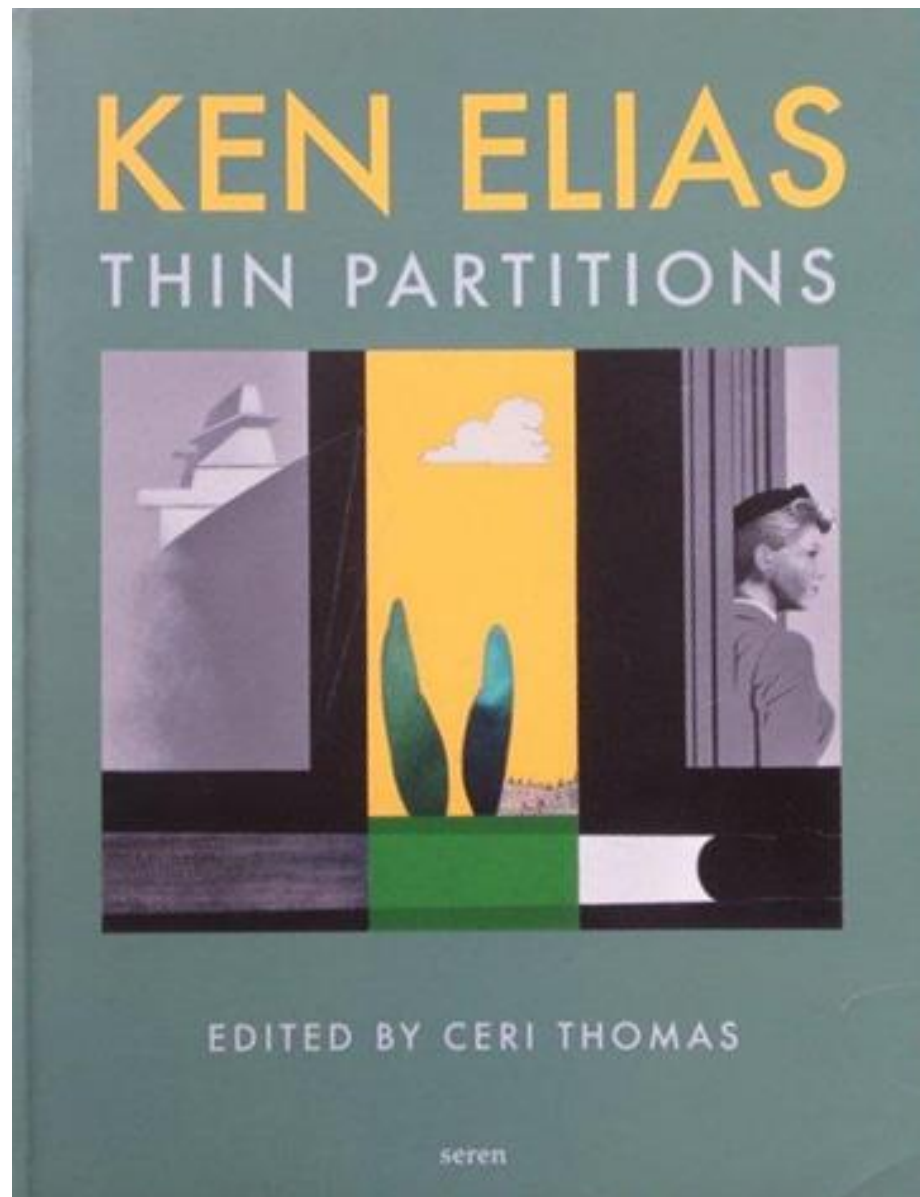

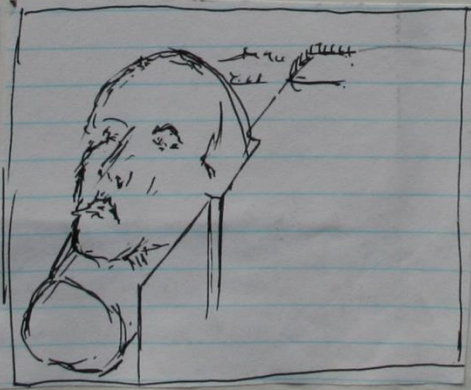

LOOK AT OTHER WORKS OF STILL-LIFE WITH LANDSCAPE BACKGROUNDS - SEE EVAN CHARLTON + BONNARD? IMPRESSIONISTS. - TABLES AT OPEN WINDOWS
 CHECK WRITTEN NOTES ON MEMORIES FOR OBJECTS ON TABLE.
 MAROON TABLE CLOTH + WHITE CLOTH SNOWBALL-WHITE HORSE. (! EMBROIDERED CLOTH)

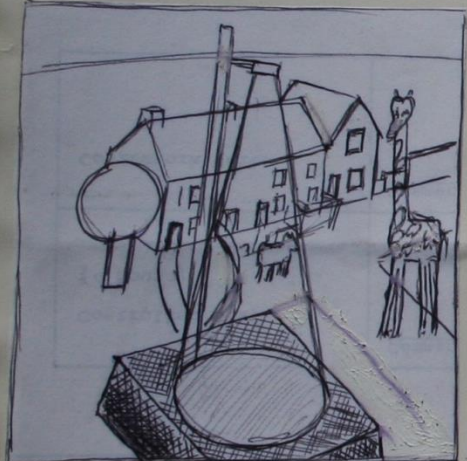
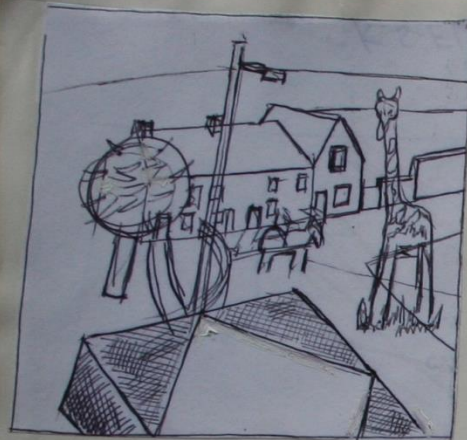

GLASS FRUIT BOWL WITH BLACK BASE.

? MONKEY ON A STICK



RED CRANE ? 1.2 OR 3 WINDOWS.



3 CHAIRS AT ADDOLDY ROAD TABLE.



BROUGHT INTO BEING AS IF THE PAST HAD NEVER BEEN W.S.
 'ALL ART IS NOSTALGIA FOR GOD. NOSTALGIA IS A LONGING TO GO HOME'
 YEVELEWSKI (RUSSIAN PAINTER)

DAYS OF FUNERAL PROCESSIONS AND POP-UP ZOO ANIMALS OR ZOO ANIMAL BOOKS

You can only die once but you can live for ever and be ashamed of yourself



Try ink wash small scale



GIOTTO MARY AND JOSEPH AND INFANT CHILD / FUNERAL PROCESSION WREATH ABOVE HOUSES AND ZOO ANIMALS



? A MODEL OF THE WELFARE HALL WITH PART OF PARK DRAWN FLATTER ON DIAMOND SHAPED TABLECLOTH

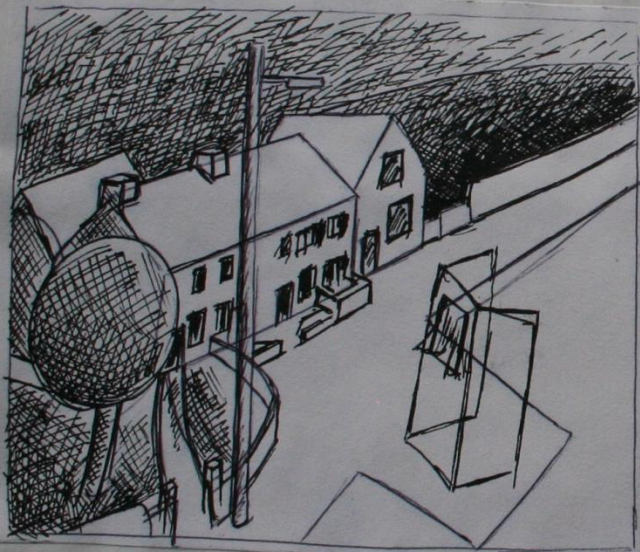

? USE OF WAX RESIST DRAWINGS TO STRENGTHEN LINKS WITH CHILDHOOD

PUPPET THEATRE ? DEVELOP COMPLEXTIONS.



MONEY BOXES

PARK AVE GALDOLI AND YELLOW WEDGE

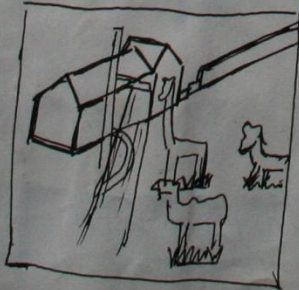

THE MEMORIES OF CHILDHOOD HAVE NO ORDER AND NO END - DYLAN THOMAS



8 ADDOLDY ROAD
EARLY DAYS
BEGINNINGS
HAPPY DAYS

? Framings from festival of Britain/Coronation dark red/white/blue to echo yellow curve of hedge. into hands of self as angel.



1953

Superman BK 1 (9)

? white horse (with saddle BK 1)

? TO REDUCE WELFARE HALL TO A SIMPLE CUBE



SEE CORONATION TEA IN CRICKET FIELD CELEBRATION PHOTOGRAPH.

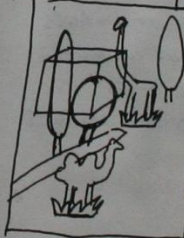

GIRAFFE AND/OR OTHER ANIMALS FROM GRAYS XMAS 1948 POPUP BOOK IN GLYNNEATH PARK OR IN ADDOLDY ROAD.

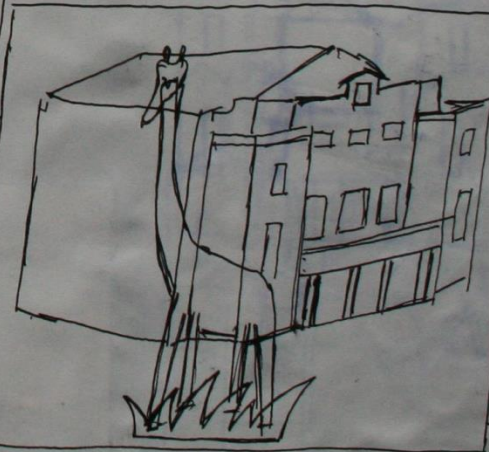

? BEANO GRANDY - ENID BLYTON IMAGERY



DISTANCE ADDOLDY ROAD TO MAKE MORE TOY LIKE ? ISOLATE IMAGES IN BLUE BACKGROUND.

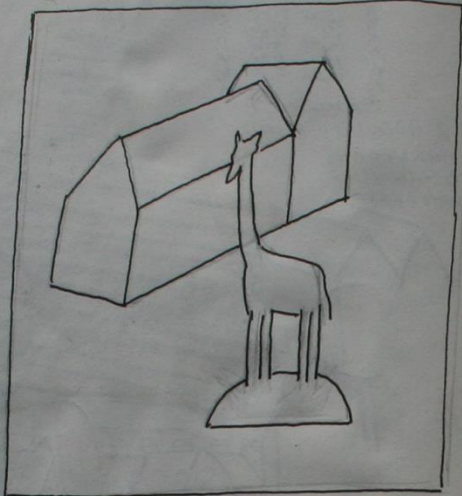
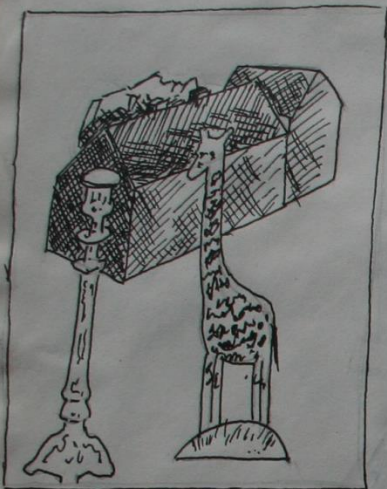

TREAT ADDOLDY ROAD AS A SHAPE - NO WINDOWS DOORS ETC.
 (? CHIMNEY) TO INCLUDE ? HEAD. CANDLESTICK GIRAFFE
 SNOWBALL SWEET DELIVERY VANS PUPPET THEATRE, FRUIT BOWL

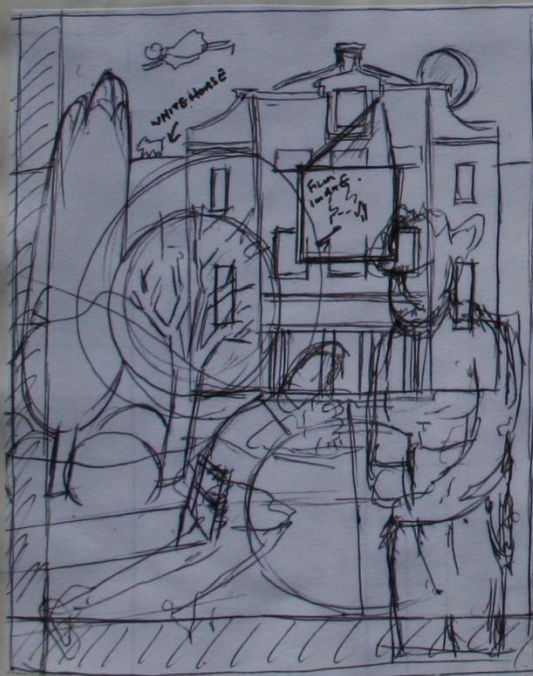

OVERLAPPING OF IMAGES
 UNDERLAYING OF COMPOSITION
 OF SQUARES + CIRCLES
 ? EXTRA CINEMA IMAGES

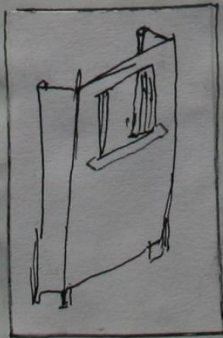

ANIMAL LIFE

IN FACT "They all stand up life-like
 FANCY when the book is opened"
 AND
 FUN.

MEANS OF ESCAPE. A CELEBRATION
 THE RED CRANE



REPEAT 'SATURDAY PICTURES'
 PAINTING - same size
 same scale. Consider
 other plots in this cubist
 style.

? MORE TABLE TOP PTGS.
 ? - CALL LIVING MODEL
 SERIES - (From BOOKANO
 ZOO BOOK)
 ? Large giraffe ptg.

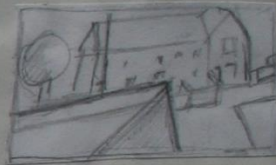

BOOKANO ZOO

"LIVING" MODELS SERIES

98	130	98	130	98	130
x4	x4	x5	x5	x6	x6
392	520	490	650	588	780

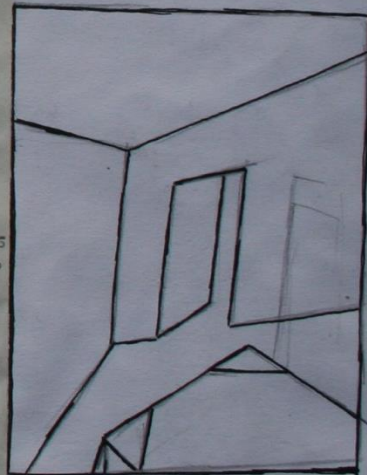

Draw pencil marks into trees in distance on ship/welfare + small road trees. pty

Daylight Addey Rd
with paper planes.

(1)



* Smoke from
Chimney No 8.

? Shadows short/long
? lamp post.

?
+ Large
coronation mug
to
where flowers + vase are in night version

** See Hopper lights from Buildings at night

crosshatch area
solid Ultramarine blue

(2)

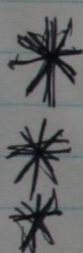

* Night
Scene.

← smaller
picture
without ship
lights from
windows

??? welfare day or night
+ images from films

(3)



↑ dark night
profiles leaning



Sketch with figure
1/2000 from the bank
1/2000 from the bank
The floor plan is
of general purpose
sketches



P. 53 William Burroughs
Frank

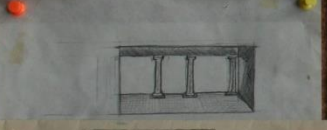
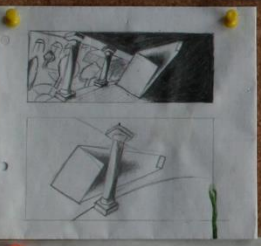
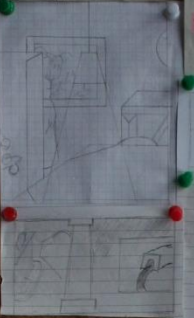

Rear Window
See earlier drawings
Change 10/3
Change 10/3
Change 10/3

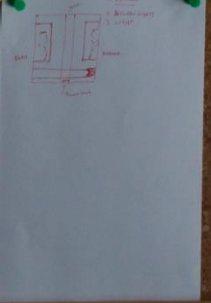
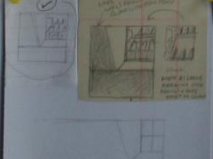
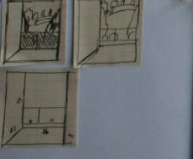
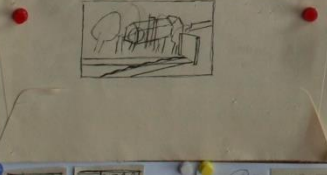
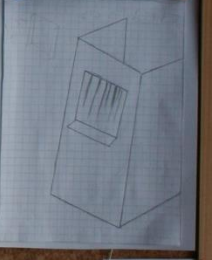

Sketch of a building's elevation, showing a central structure and surrounding spaces.

Barbara Ryan Naples 17th Sept 1944

Once before after Christmas 1942, I started a diary because I was unhappy and it helped to write things down. Now I start because I have had a faint feeling of dissatisfaction with life here, the dull days work and empty social round and the fear that I shall never, never write that novel or do anything at all worth doing. Also a faint nostalgia for the carefree unnatural life on board the Christian Huygens & Michael (LT.RN) and our talks and snatched kisses in the unsympathetic atmosphere of a troopship.

This afternoon we went to Capri. It takes about 2 hrs from Naples by boat. It is much bigger than I expected with great sheer cliffs in parts. The four of us hurried ashore, into the funicular which took us past vineyards with hanging bunches of grapes, also lemon trees, but the lemons seemed either green or maddly. The usual kinds of flowers here, royal blue convolvulus with pink inside, a rich purple climbing thing and another pale blue - I don't know the names but one must be bougainvillea. At the top we got a car and drove to Anacapri and then walked the last bit to Axel Munthe's villa. The usual beggar followed us - an orphan aged about sixty. The villa is lovely inside - full of old furniture & Roman sculptures which Munthe dug up in the garden - also Roman inscriptions - I wished I could read them - oh the agony of not knowing Latin! Very striking is a great stone head of medusa which he has on the wall over his writing desk. Apparently he saw this head in the clear water by the old foundations of Tiberius's bath. How wonderful to have seen it before anyone else did. What I liked best was a cool little courtyard full of these Roman pieces, white walled and peaceful with trees against the sky. I felt tears coming into my eyes and had to turn away. The peace, the beauty, the antiquity, perhaps something of the feeling I have for churchyards came over me. There is also a lovely corner overlooking the sea with a marble seat and an avenue of cypresses. A stone harpy on a corner wall so that it is silhouetted against the sky and sea. Also a large granite sphinx on which you can have a wish. I wished a simple wish that could come true. There is a pleasant little square in Anacapri, full of souvenirs - Corals, straw hats, cameos and little silver bells which are supposed to be lucky. Of course I bought one, being sentimental and a little superstitious. La Campanella porta fortuna.... I do hope it will. This place made me quite disinclined to go back to Naples.

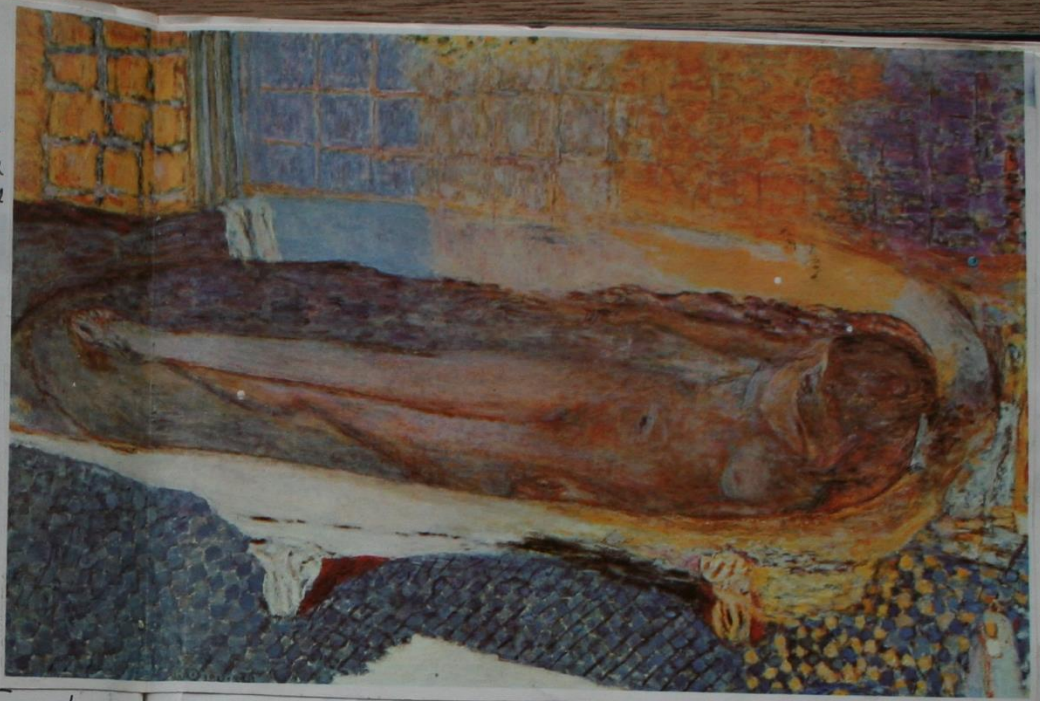

Barbara, Peter & me, returning to Capri - La Campanella porta fortuna



Boat decorated with gardens of convolvulus & bougainvillea
Head medusa / villa / garden & trees.
bus. railway bell in on boat.
horizon & development of blue lines in sky from sun.

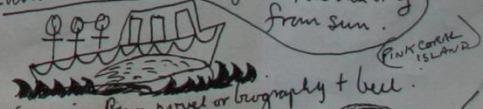

NS carrying Ryan novel or biography + bell

STEPS - Giotto Virgin's House.
Jacobi's ladder.



David Jones the Garden Brevel.



ERIC RAVILIOUS Jacob/Almanack 1929.

ON THE STAIRS - CAVAFY.

As I was going down these ill-famed stairs
you were coming through the door, and for a second
I saw you unfamiliar face and you saw mine.
Then I hid so you wouldn't see me again,
and you hurried past me, hiding your face,
and slipped inside the ill-famed house,
where you couldn't have found pleasure anymore than I did.
And yet the love you were looking for, I had to give you;
the love I was looking for - so your tired, knowing eyes
implied -
you had to give me
Our bodies sensed and sought each other:
our blood and skin understood.
But we both hid ourselves, frustrated.

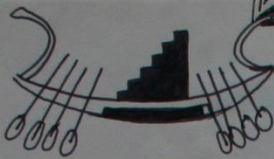

Blue stairs
Blue carpet.

Step:- the distance so covered:
a short journey; a stage
upward or downward:
a stage in discontinuous
or stairwise rise or fall:
a move towards an end
or in a course of proceeding:
a means to gradual progress:

interior
with plover
tree to
protect from
evil spirits



PICTURED. CAVAFY.

I love my work, and I'm very careful about it.
But today I'm discouraged by how slowly it's going.
The day's had a bad effect on me:
it grows darker and darker. Endless wind & rain.
I'm more in the mood for looking at things than for speaking.
In this picture I'm now gazing at, a handsome boy
is lying down close to a spring,
maybe exhausted from running.
What a handsome boy; what a heavenly moon
has caught him up in sleep.
I sit and gaze like this for a long time,
recovering through art from the effort of creating it.

AS MUCH AS YOU CAN. CAVAFY.

Even if you can't shape your life the way you want,
at least try as much as you can
not to degrade it
by too much contact with the world,
by too much activity and talk.
Do not degrade it by dragging it along,
taking it around and exposing it so often
to the daily silliness
of social relations and parties,
until it comes to seem a boring hanger-on.



Tom AN ACTOR SUNBATHING IN THE SAND DUNES



Krishna subduing the serpent. From Kangra c. 1775.

'You're never fully dressed without a smile.'

Sir Laurence Olivier. - The entertainer

Easy Street

WILLIES

? Golden Section

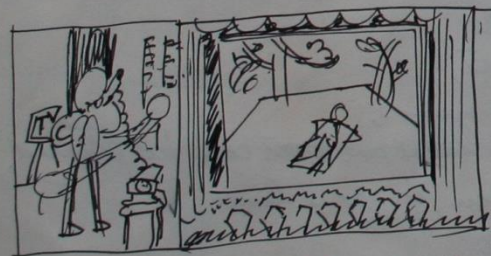

Get Tom to pose in September when he comes down to see 'Annie'

David + Huw arrange a painting of Tom on the telephone. Paint me a painting before you famous. You you pose. of course he will pose. - Fame - Value/Money. Important.

Edward Bura we do do you talk about with your friends how terrible actor



Rothenstein on David Jones - 'only through being local can something become universal. Through his happy acceptance of his Welsh ancestry and his London antecedents and all that these involve of the insular and even the provincial, his imagination reaches out to encompass a vast range of European consciousness.'

David Jones - 'I learned, I think, at least by analogy, from the doctrinal definition of the substantial Presence in the Sacramental Bread. Therefore a tree in a painting or a tree in an embroidery must not be a 're-presenting' only of a tree of sap and thrusting hood - it must really be 'a tree' under the species of paint, or needlework, or whatever. I know this analogy cannot in any way be pressed and is open to every sort of objection but for me it has its uses and it will loosely serve.'

Draw pencil marks into trees in distance on ship/welfare
+ small road trees. pty

Daylight Adelphi Rd
with paper planes. (1)



* Smoke from
Chimney No 8.

? Shadows short/long
? Lamp post.

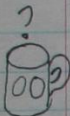

+ large
Astonation mug
to
where films + one are in night version

** See Hopper lights from Buildings at night
crosshatch area
solid Ultramarine blue



* Night
Scene.

← Smaller
picture
with on ship
lights from
windows

(3)



↑ dark night
Profiles leaning

??? welfare day or night
+ images from films

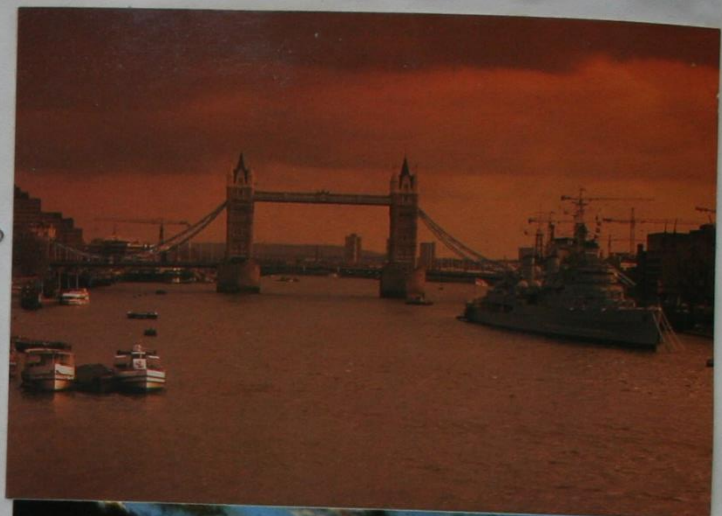



THE RUSSIAN PAINTER 'YEVLENSKI' (?sp) SAID THAT
ALL ART IS NOSTALGIA FOR GOD.
- NOSTALGIA - A LONGING TO GO HOME.

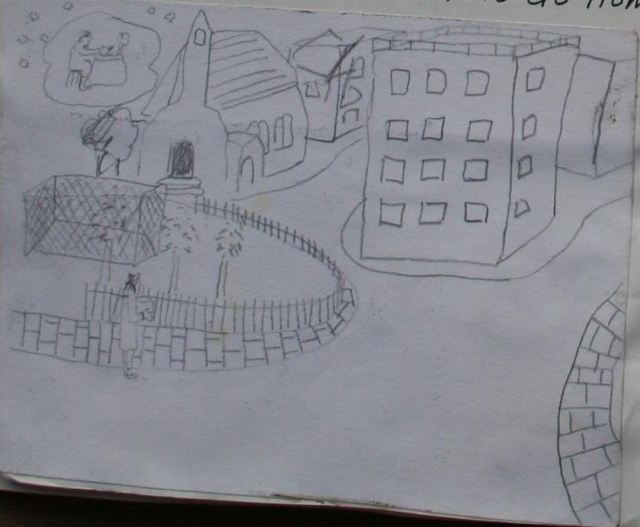

Remembering days of recovery
from childhood illness - warm
coal fires, plasticine, jigsaws
Enid Blyton, painting books
Sketch Club (Adrian Hill?)
The silver sword, Leatherette
settee and chairs, homemade
fast & Welsh cakes.

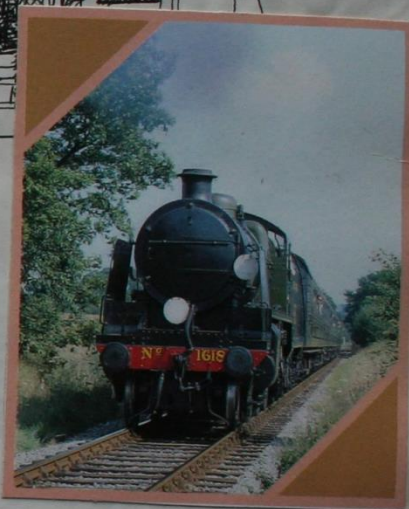

BROUGHT INTO BEING
AS IF THE PAST HAD
NEVER BEEN W.S.

'ALL ART IS NOSTALGIA
FOR GOD.
NOSTALGIA IS A
LONGING TO GO
HOME'
YEVLEWSKI (RUSSIAN
PAINTER)

DAYS OF
FUNERAL
PROCESSIONS
AND POP-UP
ZOO ANIMALS
OR ZOO ANIMAL
BOOKS

You can only die once
but you can live for ever
and be ashamed of yourself



Add??

Try ink +
wash small
scale

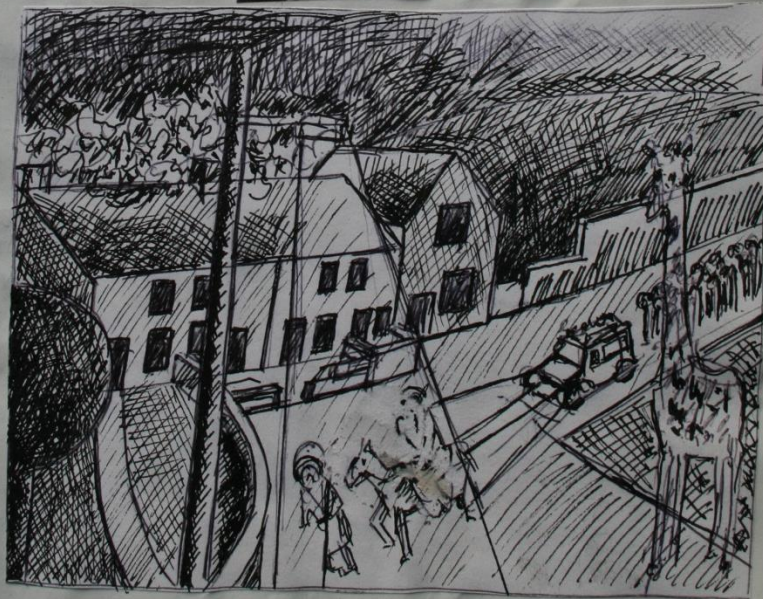
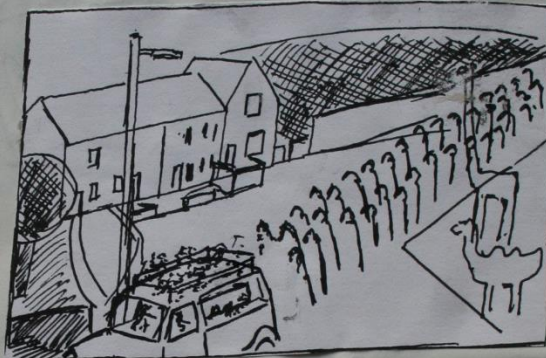

GIOTTO MARY AND JOSEPH AND INFANT CHILD / FUNERAL
PROCESSION WREATH ABOVE HOUSES AND ZOO ANIMALS



? A MODEL
OF THE
WELFARE
HALL WITH
PART OF PARK
DRAWN
FLATTER ON
DIAMOND
SHAPED
TABLE CLOTH



? USE OF
WAY RESIST
DRAWINGS
TO
STRENGTHEN
LINKS WITH
CHILDHOOD

PUPPET
TREATRE
? DEVELOP
CANDLESKICKS.

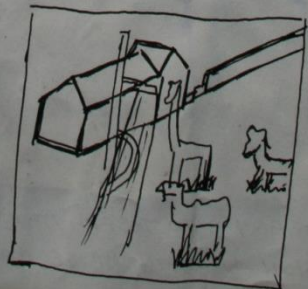

MONEY
BOXES



PARK
AVE
CALDIOLI
AND YELLOW
HEDGE.

THE MEMORIES OF CHILDHOOD HAVE NO ORDER AND NO END - DYLAN THOMAS



8 ADDOLDY ROAD
EARLY DAYS
BEGINNINGS
HAPPY DAYS

? Hummings from
Festival of Britain/Coronation
dark red/white/blue to echo
yellow curve of hedge. into



hands
of self
as
angel.

1953.

Superman Bk 1

(9)

? white horse
(with saddle Bk 1)



SEE CORONATION
TEA IN CRICKET FIELD
CELEBRATION PHOTOGRAPH.

? TO REDUCE
WELFARE HALL
TO A SIMPLE
CUBE

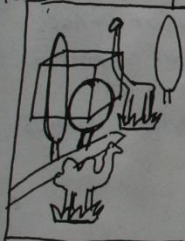

GIRAFFE AND/OR OTHER ANIMALS
FROM GRANS XMAS 1948 POP UP
BOOK IN GLYNNETH PARK OR
IN ADDOLDY ROAD.

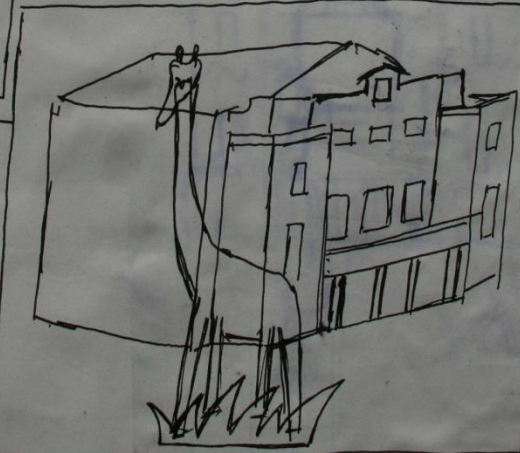

? BEANO
GRDANDY -
ENID BLYTON
IMAGERY

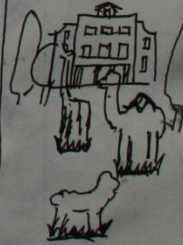

DISTANCE
ADDOLDY ROAD
TO MAKE MORE TOY LIKE
? ISOLATE IMAGES IN BLUE BACKGROUND.

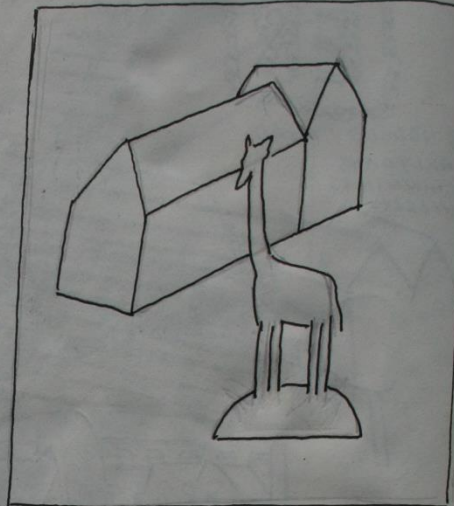
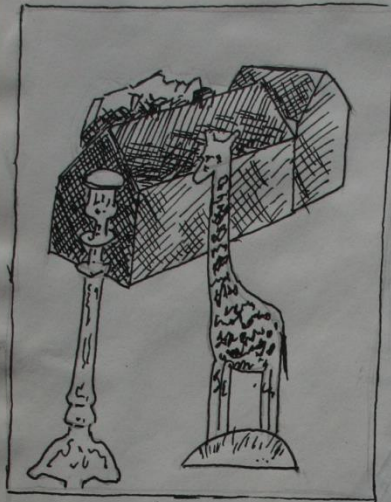

TREAT ADDOLDY ROAD AS A SHAPE - NO WINDOWS DOORS ETC.
 (? CHIMMNEY) TO INCLUDE ? HEAD. CANDLESTICK GIRAFFE
 SNOWBALL - SWEET DELIVERY VANS PUPPET THEATRE, FRUIT BOWL

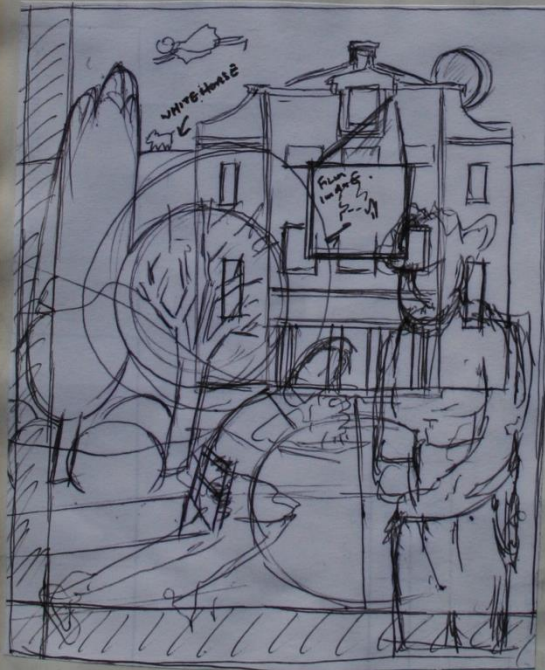

OVERLAPPING OF IMAGES
 UNDERLAYING OF COMPOSITION
 OF SQUARES + CIRCLES
 ? EXTRA CINEMA IMAGES

